

# Inductive sensor

## NJ0,8-5GM-N



- 0.8 mm flush
- Usable up to SIL 2 acc. to IEC 61508



### Dimensions

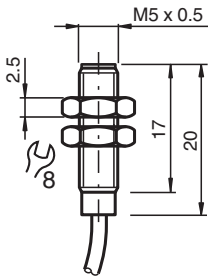

### Technical Data

General specifications			
Switching function			Normally closed (NC)
Output type			NAMUR
Rated operating distance	$s_n$		0.8 mm
Installation			flush
Assured operating distance	$s_a$		0 ... 0.65 mm
Reduction factor $r_{AI}$			0.4
Reduction factor $r_{Cu}$			0.3
Reduction factor $r_{304}$			0.85
Output type			2-wire
Nominal ratings			
Nominal voltage	$U_o$		8.2 V ( $R_i$ approx. 1 k $\Omega$ )
Operating voltage	$U_B$		5 ... 25 V
Switching frequency	$f$		0 ... 5000 Hz
Hysteresis	$H$		3 %
Suitable for 2:1 technology			yes , Reverse polarity protection diode not required
Current consumption			

Release date: 2024-05-28 Date of issue: 2024-06-02 Filename: 70133075\_eng.pdf

Refer to "General Notes Relating to Pepperl+Fuchs Product Information".

Pepperl+Fuchs Group  
www.pepperl-fuchs.com

USA: +1 330 486 0001  
fa-info@us.pepperl-fuchs.com

Germany: +49 621 776 1111  
fa-info@de.pepperl-fuchs.com

Singapore: +65 6779 9091  
fa-info@sg.pepperl-fuchs.com

PEPPERL+FUCHS

## Technical Data

Measuring plate not detected		≥ 3 mA at nominal voltage
Measuring plate detected		≤ 1 mA at nominal voltage
<b>Functional safety related parameters</b>		
Safety Integrity Level (SIL)		SIL 2
MTTF <sub>d</sub>		1050 a
Mission Time (T <sub>M</sub> )		20 a
Diagnostic Coverage (DC)		0 %
<b>Compliance with standards and directives</b>		
Standard conformity		
NAMUR		EN 60947-5-6:2000 IEC 60947-5-6:1999
Standards		EN IEC 60947-5-2
<b>Approvals and certificates</b>		
IECEX approval		
Equipment protection level Ga		IECEX PTB 11.0037X
Equipment protection level Gb		IECEX PTB 11.0037X
Equipment protection level Da		IECEX PTB 11.0037X
Equipment protection level Mb		IECEX PTB 11.0037X
ATEX approval		
Equipment protection level Ga		PTB 00 ATEX 2048 X
Equipment protection level Gb		PTB 00 ATEX 2048 X
Equipment protection level Da		PTB 00 ATEX 2048 X
UL approval		
Ordinary Location		E87056
Hazardous Location		E501628
Control drawing		116-0452
CCC approval		
Hazardous Location		2020322315002256
NEPSI approval		
NEPSI certificate		GYJ16.1393X
CML approval		on request
ANZEx		18.3018X
KCC approval		
Hazardous Location		19-AV4BO-0025X
<b>Ambient conditions</b>		
Ambient temperature		-25 ... 100 °C (-13 ... 212 °F)
<b>Mechanical specifications</b>		
Connection type		cable
Housing material		Stainless steel 1.4305 / AISI 303
Sensing face		PBT
Degree of protection		IP67
Cable		
Cable diameter		2.6 mm ± 0.2 mm
Bending radius		> 10 x cable diameter
Material		PVC
Core cross section		0.14 mm <sup>2</sup>
Length	L	2 m
Dimensions		
Length		20 mm
Diameter		5 mm
<b>General information</b>		
Use in the hazardous area		see instruction manuals

Release date: 2024-05-28 Date of issue: 2024-06-02 Filename: 70133075\_eng.pdf

Refer to "General Notes Relating to Pepperl+Fuchs Product Information".

Pepperl+Fuchs Group  
www.pepperl-fuchs.comUSA: +1 330 486 0001  
fa-info@us.pepperl-fuchs.comGermany: +49 621 776 1111  
fa-info@de.pepperl-fuchs.comSingapore: +65 6779 9091  
fa-info@sg.pepperl-fuchs.com

**PEPPERL+FUCHS**

## Connection

